

June 9, 2023

Ref: 2305  
Project No.: BRFN-014-6(44)--39-38  
PIN No.: 20-38-014-010

Paul C Geilenfeldt, PE  
Marshall County Engineer  
101 E Church St  
Marshalltown, IA 50158

Subject: IA 14 Bridge - Unspecified Project Detour Agreement with Marshall County

Dear Paul:

The Iowa Department of Transportation has scheduled a Bridge - Unspecified project for IA 14 Wolf Creek.

IA 14 will need to be closed in order to complete the project. Construction will occur in calendar year 2025, and the closure is estimated to be from May 1 to September 1. During the project, IA 14 traffic will be detoured as indicated on the enclosed map. This detour will include local agency roads and requires an Agreement for Use of Local Agency Roads as Detours.

If this is agreeable, please return a signed copy of the enclosed agreement. Upon receipt, the DOT portion will be completed, and a fully signed copy will be returned for your records.

If you have any questions, please contact me at 515-239-1194 or Benjamin.Adey@iowadot.us.

Sincerely,



Benjamin Adey  
District 1 Design Engineer

BA  
Enclosure  
cc: Allison Smyth, IA DOT, District 1  
File



### AGREEMENT FOR DOT-INITIATED DETOUR OF PRIMARY HIGHWAYS ONTO LOCAL ROADS

This Agreement is entered into by and between the Iowa Department of Transportation, hereinafter known as the DOT; and the  City Council Marshall County  County Board of Supervisors, hereinafter known as the Local Public Agency (LPA).

WHEREAS, the DOT, hereinafter known as DOT, has determined the necessity to temporarily close primary highway IA 14 from IA 96 to IA 175 for the purpose of construction, reconstruction, maintenance, natural disasters, or other emergencies that are 48 hours or longer (incident management temporary detours are covered under a separate detour agreement (Form 810076)); and

WHEREAS, it is necessary to provide a detour for the primary highway closure period; and

WHEREAS, the LPA agrees to permit the use of its roads as a detour, more particularly described as follows:

On Co Rd T29, from IA 96 to Grundy County Line;  
\_\_\_\_\_  
\_\_\_\_\_ ; and

WHEREAS, Authorized representatives of both the DOT and the LPA have jointly inspected and documented the condition of the proposed detour to reasonably reflect the condition of the roadway base, surface, shoulders and bridges; and

WHEREAS, the DOT has reviewed and inspected the bridges on the detour, if applicable. The LPA  will  will not allow  oversize and/or  overweight loads. The DOT shall approve the routing of overweight vehicles on the detour route, up to the limits specified by the LPA; and

WHEREAS, the DOT agrees to perform the following pre-detour maintenance, if any: None \_\_\_\_\_ ; and

WHEREAS, the DOT agrees to maintain the detour and provide all traffic control devices required by the Manual of Uniform Traffic Control Devices (MUTCD), as adopted by the DOT pursuant to 761 IAC 130, including the marking of no-passing zones during the period the local agency road(s) and structure(s) are being utilized as a primary road detour; and

WHEREAS, Prior to revocation of the detour, the DOT shall follow Iowa DOT Policy 600.05 for detour compensation of the LPA, and when requested by the LPA, either restore the local agency road to as good of condition as it was prior to its designation as a temporary primary road, or adequately compensate the local agency for excessive traffic or damage upon the local agency road during the period it was used as a temporary primary road, in accordance with Section 313.28 or Section 313.29 of the Iowa Code and Iowa DOT Policy 600.05; and

WHEREAS, The detour period is estimated to begin May 1, 2025 (date) and end September 1, 2025 (date) ; and

WHEREAS, the parties agree to the following additional provisions, if any: None \_\_\_\_\_

NOW, THEREFORE, BE IT AGREED that the described road be used as a detour under stipulations outlined above.

IN WITNESS WHEREOF, The parties hereto have caused this agreement to be executed by proper officers thereunto duly authorized as of the dates below indicated.

\_\_\_\_\_  
District Engineer (or designee) Date  
Iowa Department of Transportation

\_\_\_\_\_  
City representative Date

\_\_\_\_\_  
Printed name and title of city representative

\_\_\_\_\_  
County representative Date

\_\_\_\_\_  
Printed name and title of county representative

- County Border
- Detour Route
- Construction Area

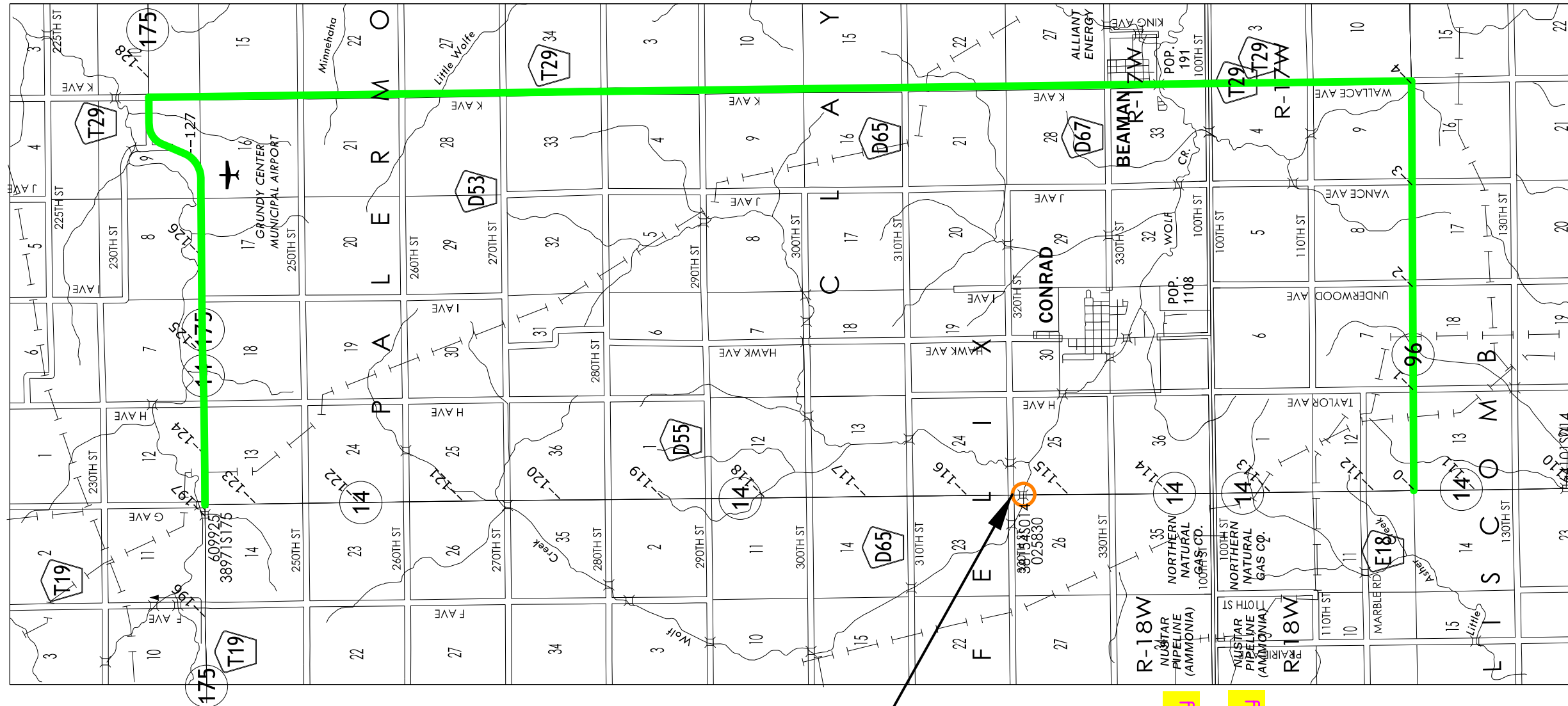

Project Location  
 MP 115.44  
 FHWA No. 25830  
 Maintenance No. 3815.4S014

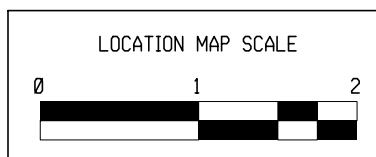

Grundy County

Marshall County

**IOWADOT**  
 Grundy County  
 Project Location Map  
 Proposed Detour Map  
 for BRFN-014-6(66)--39-38